

# Escape routes during set-up and dismantling

It is possible to use a strip of **no more than 0.9 metres in width** along the edge of the stand facing the hall aisle for the storage of construction material. Regardless of the width of the hall aisle and the items deposited there, it is mandatory to maintain an unblocked passageway of **no less than 1.2 metres in width**. Areas in front of emergency exits and areas where hall aisles intersect are the exception: their entire width must be kept clear at all times.

The **Logisticservice** provides the opportunity to store material at the Cargo Center (chargeable service), which cannot remain at your stand due to lack of space or because you need it at a later date. This material will be delivered to your stand whenever you need it during the setting up. Please contact us, by phone: +49 69 7575 6075 or mail: [logistics@messefrankfurt.com](mailto:logistics@messefrankfurt.com).

Materials required for constructing stands or exhibits delivered for immediate installation at the stand area may be deposited along the edges of the escape and rescue routes for a short period of time during the set-up and dismantling phases as long as the aisle widths required for safety reasons are maintained and logistical concerns are sufficiently taken into consideration. Hall aisles may not be used for assembly or to set up machines.

The storage of goods and materials within the red zone is forbidden. Messe Frankfurt may request the immediate clearing of all hall aisles, and is also entitled to have this done at the exhibitor's expense.

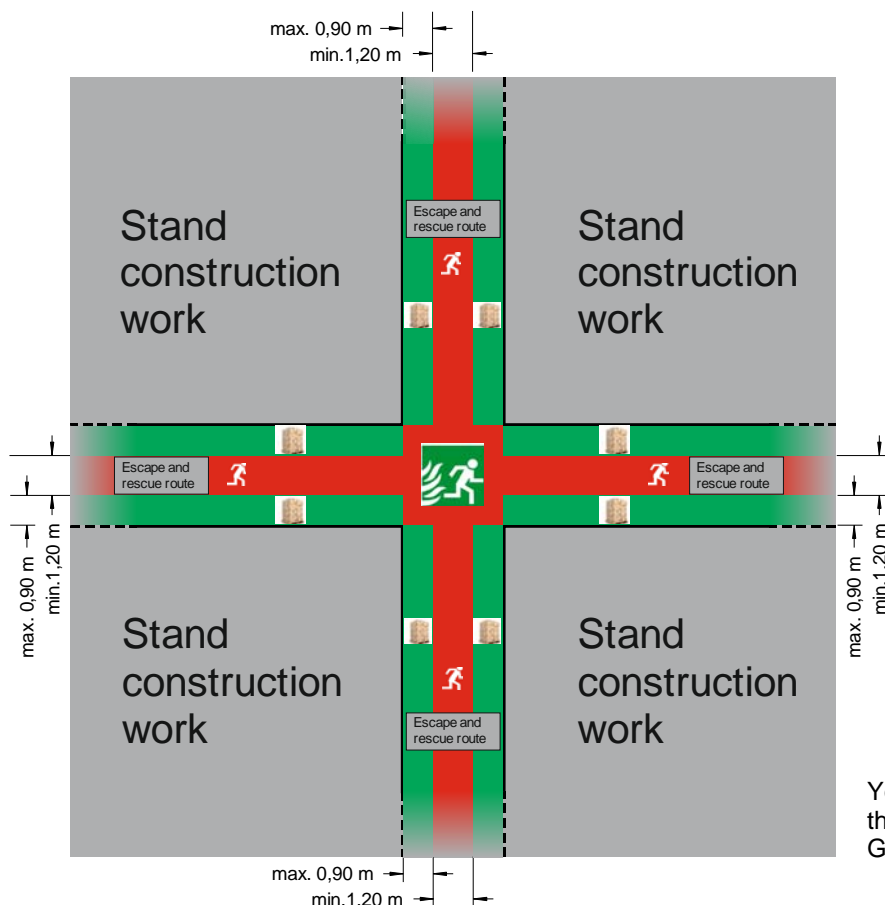

You will find additional details in the Messe Frankfurt Technical Guidelines

# Cutting and grinding work

The processing of wood and plasterboard using cutting or grinding tools in Messe Frankfurt Venue GmbH's exhibition halls is **only permissible with an appropriate dust extraction system.**



The dust that is generated by the mechanical processing of wood and plasterboard is considered to be a hazardous substance pursuant to the German Hazardous Substances Ordinance (GefStoffV, Section 8, Paragraphs 2.2 and 2.7), and is to be avoided or restricted in its entirety.

These substances are generally considered to be carcinogenic and hazardous to health pursuant to the Technical Regulations for Hazardous Substances 553 (TRGS 553).

Should these rules not be complied with, we will be forced to stop your set-up work immediately.

We therefore ask that you comply with these regulations at all times in order to ensure that your set-up work runs smoothly.

**If you require additional information, the staff at Messe Frankfurt Venue GmbH's Technical Event Management Department will be happy to assist you.**

**Phone number: +49 69 7575 – 5904.**